



2016+ Toyota Tacoma QuickLIFT Installation Guide

Step 1 - Unpack QuickLIFT system and verify contents.

Remove all items from the packing tube. You should have the following before beginning:

- | | |
|--|---------------------|
| (2) Gas springs | RT-QL-200-5A |
| (2) Black powdercoated fender brackets | 32-00019 |
| (2) Black powder-coated hood brackets | 32-00001 |
| (8) #2 Multi-grip rivets (black) | 55-00002 |
| Full-color printed instructions | |



Step 2 - Gather the required tools.

Please gather the following tools before you begin the installation:

- * Power Drill
- * 3/16" drill bit
- * Fine permanent marker or felt tip pen
- * Masking tape
- * Tape Measure
- * Hammer & center punch
- * Touch up paint
- * Rivet gun, capable of 3/16" rivets (most brands can handle this size)

Note: Only use the rivets supplied in the QuickLIFT system and do not substitute rivets with screws, bolts etc...

Step 3 - Mark driver's side hood bracket location.

A. Open hood and face the inside hood frame (driver's side first). Place the end of the tape measure up against the top of the hood hinge (See Figure 1) and place a horizontal mark at exactly **19"** on masking tape or align edge or tape to this dimension (See Figure 2).

B. Align the bottom edge of the bracket with the tape or mark you made - the ball-stud should be pointing outward or away from vehicle. The base of the bracket should be approximately **2-1/2"** from the hood's edge when viewed from front of vehicle (See Figure 3). Mark the center of the lower hole using a permanent marker - double check measurements and use photos in following steps for clarification if needed.

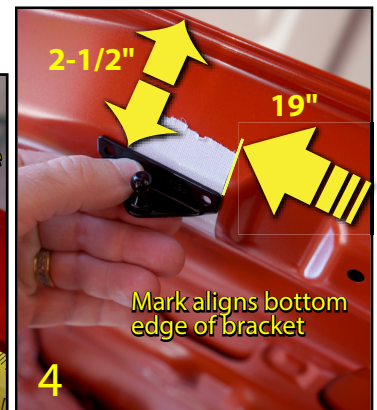
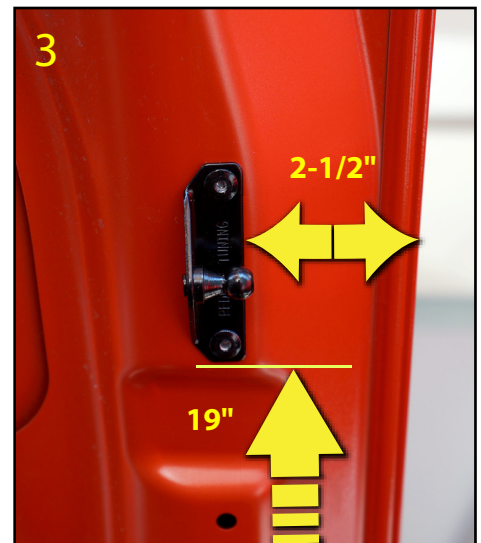

Step 4 - Align driver's side hood bracket and mark the 1st hole.

A. Using a center punch and a hammer, tap the center of the dot you just made (the indentation will help guide the drill bit and keep it from wandering).

Place bracket back in place to be sure it is still centered where it should be before moving to Step 5. Set bracket aside.



Step 5 - Drill a 3/16" hole.

A. Carefully drill the lower bracket hole as shown to the right using a **3/16" drill bit**. Wrap a piece of electrical tape 1/4" down from the tip - this will keep bit from passing through and hitting the hood skin. Test fit the rivet - it should be a snug but should fit through hole.

We recommend using touch up paint to coat any bare metal when drilling holes.



Step 6 - Rivet 1st side of bracket to hood.

A. With the bracket in place, insert a rivet through the bracket and hole with the long stem sticking outward. The rivet may require a few twists while firmly pushing it in. Hold bracket in place using a piece of tape at the other end of the bracket.

B. Check to be sure your rivet gun has the 3/16" rivet head installed, then slide rivet into gun. While applying force to the rivet and bracket, firmly squeeze riveter handle multiple times until rivet gun pops and snaps off the rivet stem. **Be careful when rivet stem snaps off not to scratch paint.**



Step 7 - Drill 2nd hole and rivet bracket into place.

A. Use center punch to indent center of upper hole before drilling. Carefully drill the second hole leaving the bracket in place. **Be careful not to drill up through top of the hood. Heed the warnings mentioned earlier.**

B. Repeat on passenger side of vehicle with bracket aiming outward using the same measurements (Steps 3-7).

Prepare for next steps by removing fender trim piece, this will be reinstalled after fender bracket is mounted.



Step 8 - Position and mark first hole for driver's side fender bracket.

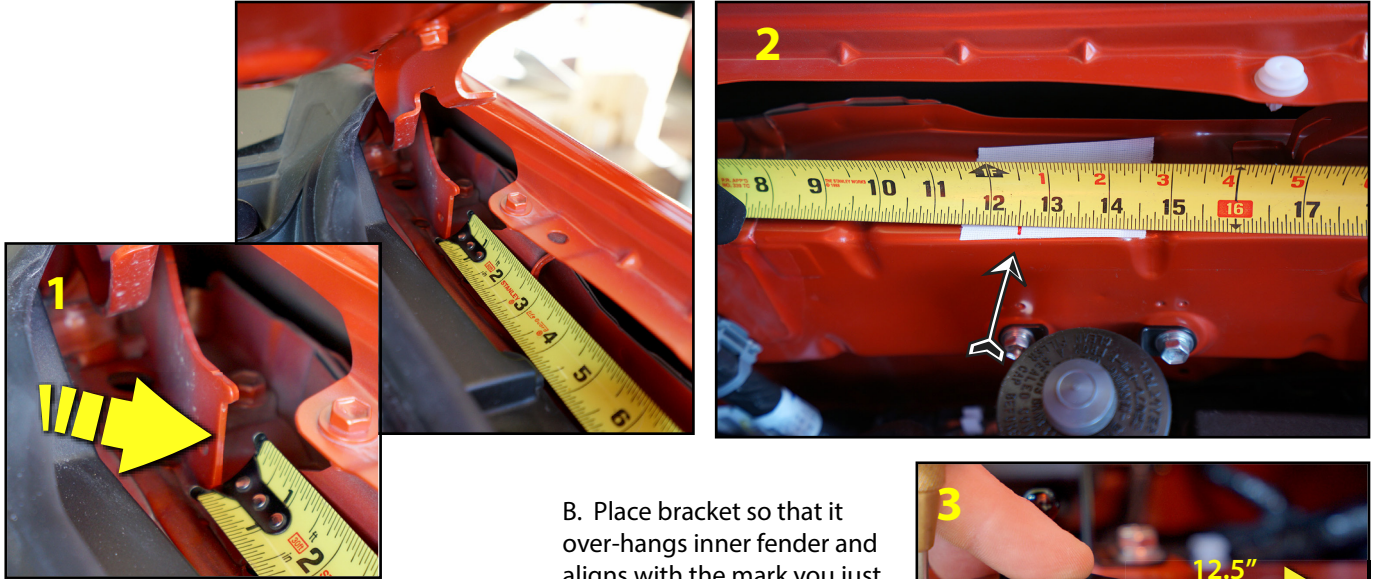

A. Measure and mark **12-1/2"** from the front vertical steel behind fender support and put a mark on tape. The bracket will be positioned starting from this line past the 12-1/2" measurement (See Figure 3)

B. Place bracket so that it over-hangs inner fender and aligns with the mark you just made. The ball-stud should be pointing inward toward engine and lower than the mounting point. Mark the center of the right hole.

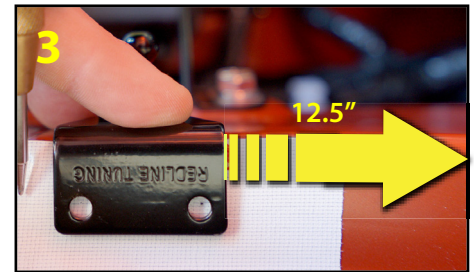

Step 9 - Mark hole center and then drill hole using 3/16" drill bit.

A. Using a center punch and a hammer, tap the center of the marked hole. This will help guide the drill bit and keep it from wandering.

B. Drill 3/16" hole.

C. Rivet into place.



Step 10 - Rivet 2nd hole, repeat on passenger side.

A. Repeat for the second hole. The vehicle is symmetrical so the same locators can be used. Feel free to measure off of key areas to ensure a symmetrical installation.

B. Once completed, install the inner fender beauty cover that was removed in Step 7.

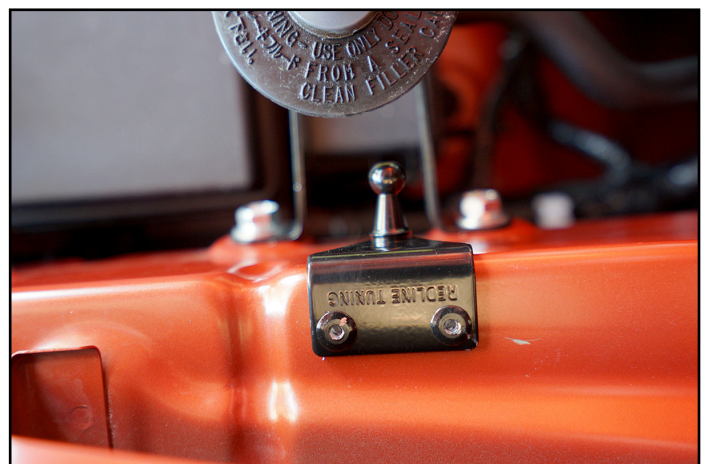

Step 11 - Install gas springs

A. Install the gas springs with the cylinder at the top (larger diameter end up and connected to the hood's ball stud). Be sure that the gas spring sockets snap securely onto the ball studs.



Enjoy your Hood QuickLIFT System

How To Remove Struts:

Slide a small flat blade screw driver under the metal C-clip. Lift and rotate C-clip toward end as shown (DO NOT REMOVE C-CLIP). Gas spring will pop off of ball-stud.

Press c-clip back into position and the gas spring is ready to reinstall.

